

ANTHEM®

AVM 60
A / V PROCESSOR

NEW! **ARC GENESIS** 

For Mac and PC



ARC® Genesis is Anthem's latest and most advanced room correction software.

NEW
11.2-CHANNEL
AUDIO/VIDEO
PROCESSOR



FREE AVM 60 CONTROL APP*

AVM 60
11.2 CHANNELS

- Dolby Atmos
- DTS:X Ready
- ARC™ Anthem Room Correction
- 4 Speaker Profile Memories

- Quad Core Digital Signal Processing
- Two Sub Out Jacks (parallel)
- Premium 32-bit / 768 kHz Differential-Output D/A Converters
- Wireless Network Connection
- DTS Play-Fi® – Local and Streaming

HDMI & VIDEO

- HDMI 2.0a
- HDCP 2.2
- 4:4:4 Subsampling at 4K60 (18.2 Gbps)
- High Dynamic Range (HDR)
- Dolby Vision™ Compatible
- Hybrid Log Gamma (HLG)
- BT.2020 Color Gamut

- On-Screen Display with 4K 50/60
- 4K 50/60 Switching

ARC 

- Works on ALL Channels
- Improved Algorithms for seamless integration between speakers and subwoofers

Few A/V Pre-amplifier-Processors offer the innovation and performance found in the all new AVM 60.

Features include Dolby Atmos immersive audio decoding, future upgrade for DTS:X, support for UHD Blu-ray and 4K60 through HDMI 2.0a with HDR, HDCP 2.2 and 18.2

Gbps are also included allowing switching for compatibility with the latest video formats.

Audiophile-friendly features include a toroidal power supply, premium differential-output D/A converters with 32-bit conversion and sampling rate optimized filters for hi-res sound. Premium A/D converters with 106

dB signal to noise ratio ensure the highest-quality sound when using analog sources.

DTS Play-Fi offers easy-to-use music playback from popular streaming services and locally networked sources, controlled through iOS, Android or PC apps.



Anthem Room Correction (ARC®) Transform the sound in any space.

ARC®
GENESIS



ARC Microphone

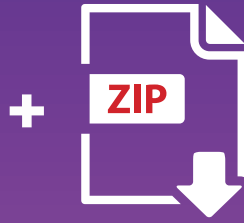

ARC® Genesis Software
(free download)



Mac OS X



Windows

ARC Genesis works with Mac or PC and is the most comprehensive method of transforming the sound in your room. Includes many new features. Download the FREE software at anthemav.com

ARC® mobile



Download App



This method uses the device's
internal microphone.

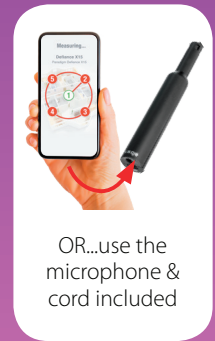
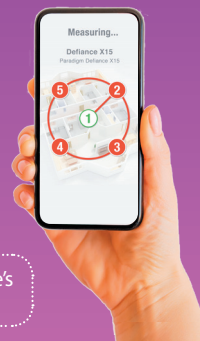

OR...use the
microphone &
cord included

The FREE ARC Mobile app transforms the sound in any room using your smartphone.

BRING YOUR MOVIES TO LIFE, AS NEVER BEFORE

DOLBY ATMOS®



What is Dolby Atmos?

Dolby Atmos® is a revolutionary new audio technology that transports you into extraordinary

entertainment experiences.

- Fills your room with captivating sound
 - Sound comes from all directions, including overhead, to fill the room with astonishing clarity, richness, detail, and depth.
- Puts sounds into motion all around you
 - The specific sounds of people, music, and things move all around you in multidimensional space, so you feel like you are inside the action.
- Delivers the full impact of the artist's work
 - Artists have amazing new capabilities to tell their stories, accent their games, or perform their music to achieve the greatest expressive impact.

How does Dolby Atmos audio work?

Dolby Atmos is the first home theater system that is based not on channels but on audio objects. What is an audio object? Any sound heard in a movie scene—a child yelling, a helicopter taking off, a car horn blaring—is an audio object. Filmmakers using Dolby Atmos can decide exactly where those sounds should originate and precisely where they move as the scene develops.

Thinking about sound in this way eliminates many of the limitations of channel-based audio. In a channel-based system, filmmakers have to think about the speaker setup: Should this sound come from the left rear surrounds or the left side surrounds? With Dolby Atmos, filmmakers just have to think about the story: Where is that yelling child going to run? How will the helicopter move overhead after takeoff? The Dolby Atmos system, whether in the cinema or the home theater, has the intelligence to determine what speakers

to use to precisely recreate the child's movement in the way the filmmakers intend. They can now precisely place and move sounds as independent objects in multidimensional space, including anywhere overhead, so you can hear them as you would naturally. reality to your listening experience. Dolby Atmos helps weave the audio story to match what's happening on the screen.

Dolby®-Enabled Height Speakers

2 or 4 may be used, 6 positions shown
External amplification may be required

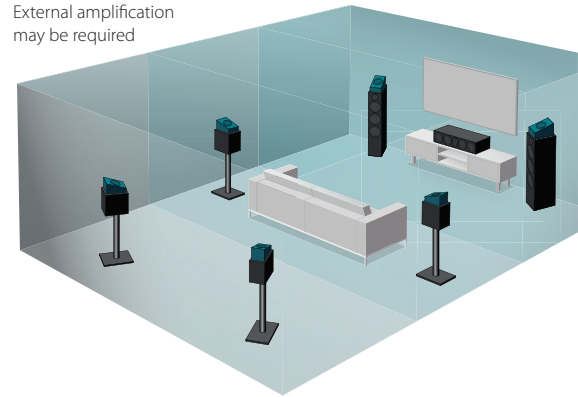

DTS:X READY



What is DTS:X?

DTS:X is the next generation audio codec from DTS that leverages object-based audio to enable new audio experiences in immersion and interactivity.

DTS:X places sound where it would occur naturally in space, creating the most lifelike, multi-dimensional audio experience ever. Free from channel restrictions, sound can be placed and moved to where you would hear it in the real world. Because DTS:X doesn't require any specific speaker layout, you can arrange your home theater system however you want it. With DTS:X you're in control of your listening experience. That hard-to-hear line in a movie can be lifted out of the background sounds for a more personal entertainment experience.

Works With All DTS Content

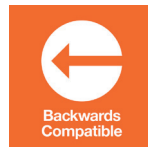

DTS will playback all DTS formats including DTS Digital Surround and DTS-HD Master Audio. DTS:X bitstreams are backward-compatible with older DTS AVRs and sound great.

Object-Based Audio

An audio object is the combination of the waveform where captures the audio, and metadata which represents the spatial location in which the object should be heard. Audio objects free content from specific speaker layouts for optimal listening.

This means the same DTS:X content will sound great whether it's rendered on stereo or a fully immersive surround sound system.

Immersive



DTS:X places sound where it would occur naturally in space, creating the most lifelike, multi-dimensional audio experience ever. Be prepared — this improved immersion and heightened realism makes horror movies scarier, comedies more laugh-out-loud, and car chase scenes even more

Interactive



You are in control of your listening experience. That hard-to-hear line in a movie can be improved at a touch — lift the dialogue out from the background sounds when you want clarity and experience a more personal entertainment experience.

WI-FI MUSIC STREAMING

DTS PLAY-FI®



Limitless music.
App-controlled convenience.
Wireless connectivity.
 Everyone wants instant access to their digital

audio library, anywhere in the home. And Anthem's MRX Series with DTS Play-Fi technology is the perfect, high-performance means of delivery.

Anthem MRX A/V Receivers can take full dynamic advantage of the better-than-CD-quality sound quality delivered by the DTS Play-Fi® streaming technology.

Partnered with the leader in Wi-Fi streaming.

DTS Play-Fi Wi-Fi streaming technology supports a host of high quality file formats. Controlled directly from your smart device or computer in any operating system, the "Open Ecosystem" of DTS Play-Fi technology makes it easy to stream music throughout your home, and to add more wireless streaming devices on the fly.

Features and Functions:

- **All the music in the world at your control**
 Stream from your digital music library or an online audio service like Spotify, Songza, Pandora, and more ...

Your Music



Music Services

To learn more about the latest subscription-based music services visit our website.

- **FREE DTS Play-Fi app** that's easy to set up on any smart device, with an intuitive interface, and the ultimate audio flexibility.

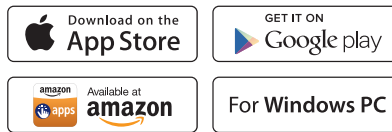

Stream via DTS Play-Fi using Android, iOS, or PC

Formats Supported by DTS Play-Fi®

Uncompressed 	Lossless	FLAC (Free Lossless Audio Codec)	54 MB for Average Song
		WAV (Waveform Audio File Format)	54 MB for Average Song
Compressed	Lossless	FLAC (Free Lossless Audio Codec)	27 MB for Average Song
		ALAC (Apple Lossless Audio Codec)	27 MB for Average Song
	Lossy	MP3 (MPEG-1 or MPEG-2 Audio Layer III)	7 MB for Average Song
		AAC (Advanced Audio Coding)	7 MB for Average Song

COMPARISON CHART

	AVM 60	MRX 1120	MRX 720	MRX 520
AUDIO FEATURES				
Preamplifier Channels	11.2	11.2	11.2	5.2
Amplifier Channels		11	7	5
Dolby Atmos	•	•	•	
Dolby TrueHD	•	•	•	•
DTS:X Ready	•	•	•	
DTS-HD Master Audio	•	•	•	•
Anthem Room Correction	•	•	•	•
Speaker Profile Memories	4	4	4	4
Crossover Settings	40-250 Hz	40-250 Hz	40-250 Hz	40-250 Hz
Digital Signal Processor	Quad-Core 32-bit	Quad-Core 32-bit	Quad-Core 32-bit	Tri-Core 32-bit
Lip-Sync Adjustment Range	300 ms	300 ms	300 ms	300 ms
Dolby Volume	•	•	•	•
DTS Play-Fi® Music Player – Local and Streaming	•	•	•	
Spotify Connect	•	•	•	
FM Tuner	•	•	•	•
Optical Inputs	3	3	3	3
Coaxial Inputs	2	2	2	2
All Digital Inputs Accept 24-Bit / 192 kHz	•	•	•	•
Stereo Analog Inputs	5	5	5	5
Analog Direct Mode	•	•	•	•
Premium 768 kHz / 32-Bit Differential-Output D/A Converters	•	•	•	•
32-Bit Conversion for all Digital and Analog-DSP Sources	•	•	•	•
Sampling Rate Optimized D/A Filters	•	•	•	•
True Balanced XLR Pre-Out	•			
Subwoofer Jacks (parallel)	2	2	2	2
Optical Output (passthrough of coax/optical in)	•	•	•	•
Any Source Downmix to Line-Out	•	•	•	•
Any Source Downmix to Zone 2 (if following Main source)	•	•	•	•
Zone 2 Plays 2-channel Optical/Coaxial Sources	•	•	•	•
Zone 2 Plays Analog Sources	•	•	•	•
LISTENING MODES				
AnthemLogic	11.2 channels	11.2 channels	11.2 channels	5.2 channels
Dolby Surround	•	•	•	
Dolby Pro Logic II				•
DTS Neo:6	•	•	•	•
All Channels	•	•	•	•

COMPARISON CHART

	AVM 60	MRX 1120	MRX 720	MRX 520
HDMI AND VIDEO PROCESSING				
Inputs – Rear	7	7	7	7
Input – Front	•	•	•	
MHL – Supported Inputs	1R+1F	1R+1F	1R+1F	1R
HDCP 2.2	•	•	•	•
HDMI 2.0a	•	•	•	•
On-Screen Display with UHD 4K 50/60	•	•	•	•
4:4:4 Chroma Subsampling at 4K60 (18.2 Gbps)	•	•	•	•
High Dynamic Range (HDR)	•	•	•	•
BT.2020 Color	•	•	•	•
xvYCC, Adobe RGB, Adobe YCC601, sYCC601, Deep Color	•	•	•	•
Outputs (parallel)	2	2	2	2
Consumer Electronic Control (CEC)	•	•	•	•
Audio Return Channel	•	•	•	•
Standby Pass-Through	•	•	•	•
NETWORK CONNECTION				
Wireless	•	•	•	
Ethernet	•	•	•	•
CUSTOM INSTALLATION				
IP Control	•	•	•	•
RS-232 Control	•	•	•	•
Control System Drivers	•	•	•	•
IR Input	•	•	•	•
12V Trigger Output (configurable)	•	•	•	•
Rackmount Kit (sold separately)	•	•	•	•
ADDITIONAL FEATURES				
Toroidal Transformer	•	•		
Advanced Load Monitoring		•	•	•
Input Configurations	30	30	30	30
Power-On Input Assignment	•	•	•	•
Auto Power Off	•	•	•	•
Eco Mode for Standby	•	•	•	•
Front USB Port for Updates	•	•	•	•
Backlit Remote Control	•	•	•	•
Android Remote Control App	•	•	•	•
iOS Remote Control App	•	•	•	•
Warranty (US/Canada)	3 years	3 years	3 years	3 years

*MRX Series products included for reference only

DESIGN DETAILS



Wireless network connectivity



Easy-to-read intuitive display



Brushed anodized aluminum aesthetic

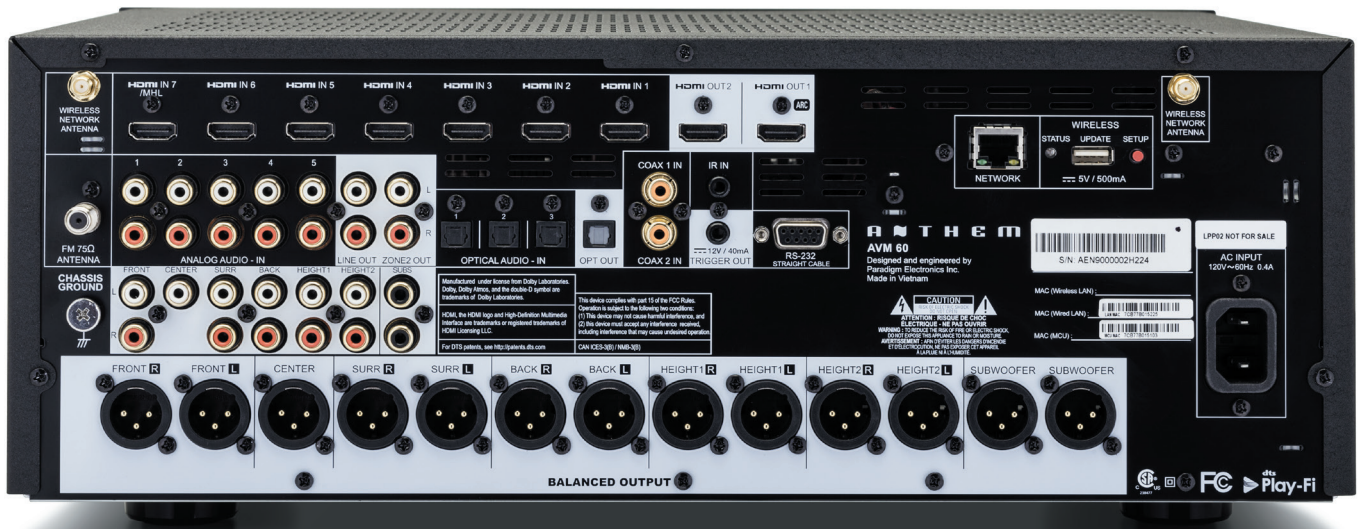

AVM 60 rear view



TECHNICAL SPECS

Preamplifier (measured at XLR output)

Maximum Output (<0.1% THD)84 Vrms, subwoofer channel 9.9 Vrms
Frequency Response (2 Vrms output)	10 Hz - 35 kHz (+0, -.25 dB)
Frequency Response, Analog-Direct (2 Vrms output)	10 Hz - 80 kHz (+0, -.25 dB)
THD+N (2 Vrms output)	-.95 dB
S/N Ratio (2 Vrms output, IEC-A filter)	110 dB

Power Consumption

Typical Load60 W
Standby03 W
Standby IP Control Enabled	4.7 W
Standby HDMI Bypass Enabled82 W

Dimensions

Height6-1/2" / 16.5 cm
Height with Rackmount Kit4U
Width	17-1/4" / 43.9 cm
Depth (not including power cord)	14-1/2" / 36.4 cm

Weight (unpacked)

AVM 6020 lb / 9 kg
------------------	---------------



AVM 60 A/V Processor Remote

CREATE YOUR
OWN DOLBY ATMOS
11-CHANNEL SYSTEM



AVM 60 Preamplifier teamed with
two MCA 325s and a MCA 525



Copyright © Paradigm Electronics Inc. All rights reserved. We reserve the right to change specifications and/or features without notice as design improvements are incorporated. www.anthemAV.com.